

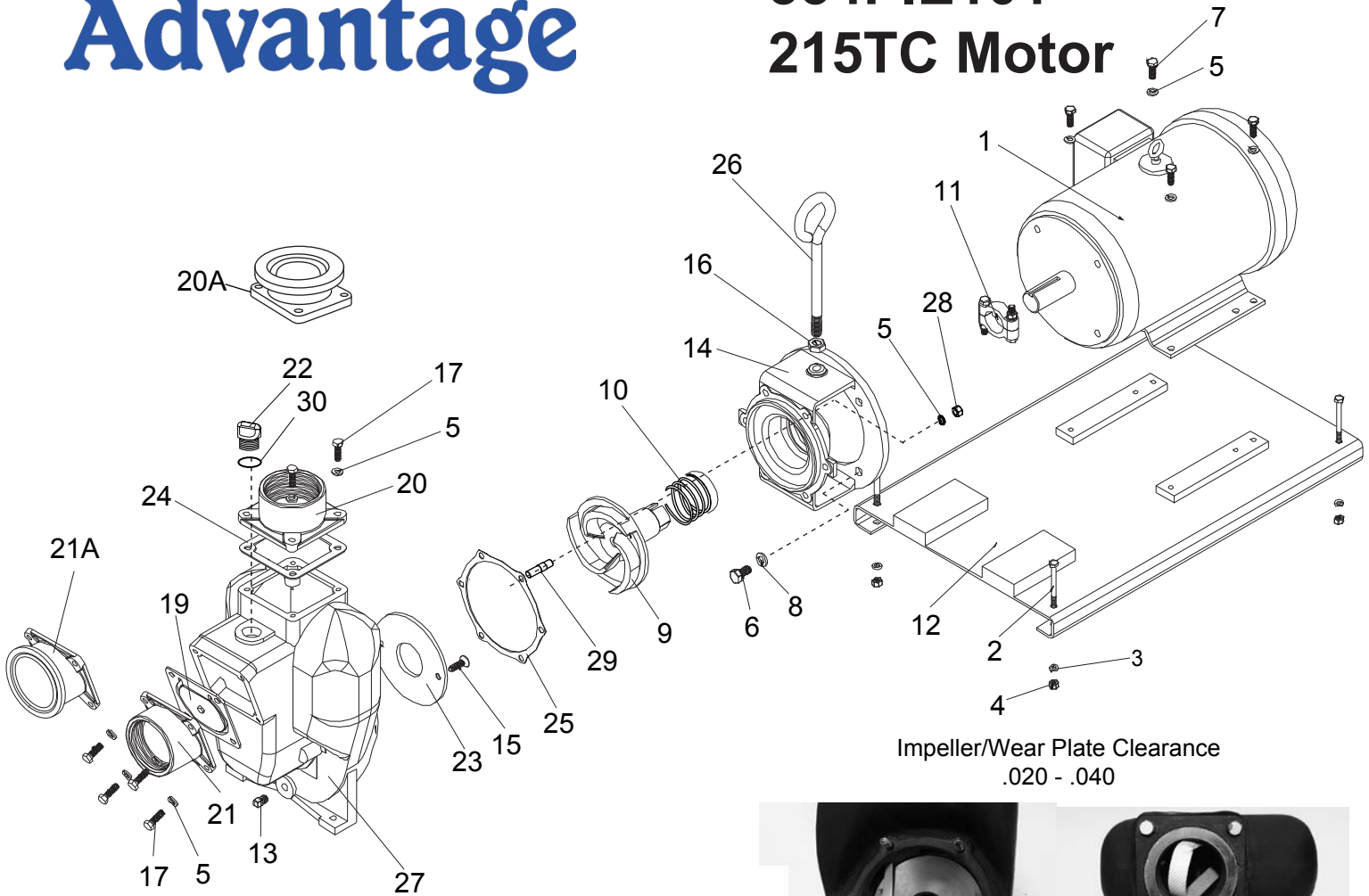

3" Cast Iron Pump W/Electric Motor 334PIE10 334PIE101 215TC Motor



Impeller/Wear Plate Clearance
.020 - .040



Place spacer between wear plate and impeller
and do not remove until bolted to drive shaft



REF NO.	PART NO.	DESCRIPTION	QTY.
1	BEM10	10 HP 3 Phase Baldor Motor 215TC 1-3/8" Shaft	1
	BEM101	10 HP Single Phase Bald or Motor 215TC	1
2	BF108	Bolt 5/16-18 X 3-1/4SS	4
3	V10118	Lock Washer 5/16" SS	4
4	V10119	Nut, 5/16" SS	4
5	V20018	Lock Washer, 3/8" SS	4
6	17449	Bolt, 1/2-13 X 1-1/4"	4
7	17704	Bolt, 3/8-16 X 1 1/4"	4
8	18058	Lock Washer, 1/2"	4
9	18423	Imp/Drive Shaft 6" Dia 1-3/8" (Elec Motor)	1
10	18425	Seal Assembly, 1-3/8" Shaft	1
11	18429	Clamp, SS 1-3/8" Shaft	1
12	18741	Base Plate 215 TC Motor	1
14	18448	Adapter 215TC Motor	1
15	18005	3/8-16 X 1-1/4" FHSCS	2
16	18034	Nut, 5/8-11 Jam	1
17	18010	3/8-16 X 1-1/8" HHCS	8

REF. NO.	PART NO.	DESCRIPTION	QTY.
18	18002	Drain Plug	1
19	18013	Check Valve Gasket Assembly (EPDM)	1
	18013BN	Check Valve Gasket Assembly (BUNA)	1
20	18008	Flange, Outlet 3" NPT	1
20A	M18008	Flange Outlet, Manifold	1
21	18012	Flange Inlet, 3" NPT	1
21A	M18012	Flange Inlet Manifold	1
22	13777	Drain Plug, 1"	1
23	18004	Wear Plate	1
24	18009	Outlet Gasket (EPDM)	1
	18009BN	Outlet Gasket (Buna)	1
25	18021	Gasket Adapter	1
26	18033	Handle	1
27	18001	Housing	1
28	18032	Nut 3/8-24	6
29	18018	Housing Stud	6
30	13778	O-Ring	1