

# Banjo 2" Hydraulic Driven Pump

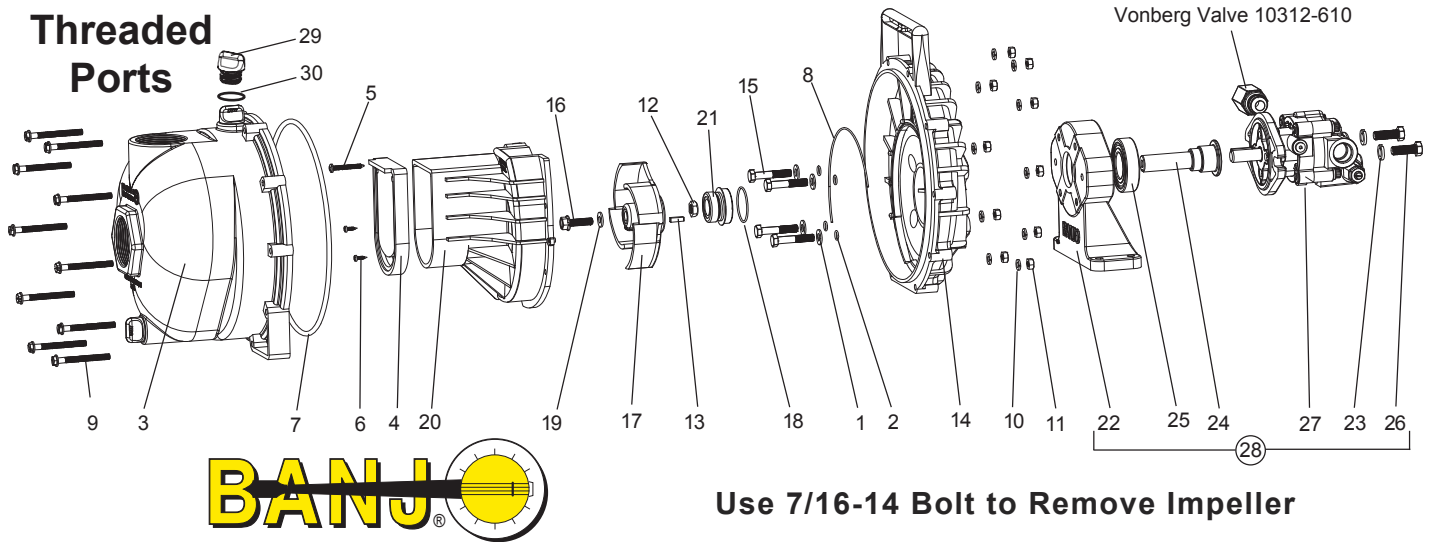

Use 7/16-14 Bolt to Remove Impeller

REPLACEMENT PARTS 2" POLY PUMPS W/ HYDRAULIC ADAPTER			
ITEM	PART NO	DESCRIPTION	QTY
1	12901	SS Rear Bracket Washer	1
2	12717	O-Ring for Screw Heads	4
2	12717V	FKM (viton type) O-Ring for Screw Heads	4
3	12712A	Body Assembly, Threaded	1
	M12712	Body Assembly, Manifold	1
4	12705	Poly Pump Check Valve	1
	12705V	FKM (viton type) Pump Check Valve	1
5	12900	SS Upper Volute Screw	4
6	12725	SS Volute Screws	2
7	12719A	Body O-Ring	1
8	12754	O-Ring Segment	1
	12754V	FKM (viton type) O-Ring Segment	1
9	12720	SS Body Screws	10
10	V07018	SS Lock Washers	10
11	V07019	SS Body Nuts	10
12	12775A	Impeller Hex Nut	1
13	12902A	Impeller Key	1
14	12703A	Poly Pump Rear Bracket	1
15	12715A	5/16"-24 x 1.75" HHCS	4
16	12765A	SS Impeller Bolt	1
17	13771	4 Vane Impeller	1
	12772	5 Vane Impeller	1
18	12710	O-Ring for Seal Assembly	1
	12710V	FKM (viton type) O-Ring for Seal Assembly	1
19	12774VA	Impeller Bolt Gasket	1
	13702	Volute, 4 Vane Impeller	1
	12702A	Volute, 5 Vane Impeller	1
20	13702	Volute, 4 Vane Impeller	1
	12702A	Volute, 5 Vane Impeller	1
21	12713	Mechanical Seal Assembly	1
22	12049B	Hydraulic Pedestal Housing	1
23	V20018	3/8" Lock Washer	2
24	12055B	Adapter Shaft	1
25	17056	Bearing	1
26	18010SS	3/8"-16 x 1.25" HHCS	2
27	HY1013	Hydraulic Motor	1
28	12600B	Complete Hydraulic Assembly	1
29	13777	Drain Plug	2

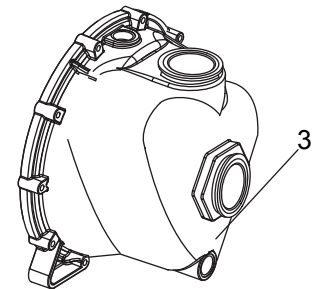

Manifold Ports

**Spray Advantage**

HYDRAULIC MOTOR DATA  
 U.S. Gallons/Rev. 0.0025  
 Cubic Inches/Rev. 0.580  
 Liters/Rev. 0.0097

Max Hydraulic Pressure 2000 PSI  
 Min Hydraulic Pressure 200 PSI  
 Inlet Port SAE 10 (7/8-14 UNF-2B)  
 Outlet Port SAE 10 (7/8-14 UNF-2B)  
 Minimum GPM Required 6 GPM 2400 RPM  
 Maximum GPM Required 10 GPM 4000 RPM  
 Ideal GPM Required 9 GPM 3600 RPM

CONNECTION INFORMATION  
 Inlet "A" Port  
 Outlet "B" Port

Supplied check valve is to ensure proper rotation of the Banjo pump. Place check valve in outlet port (marked "B") for proper right hand rotation.

SPOOL VALVE INFORMATION  
 Required Outlet Flow Min 6 GPM / Max 10 GPM  
 Required System Pressure Min 600 PSI / Max 3000 PSI