

SP-3320 (3" SELF-PRIMING)

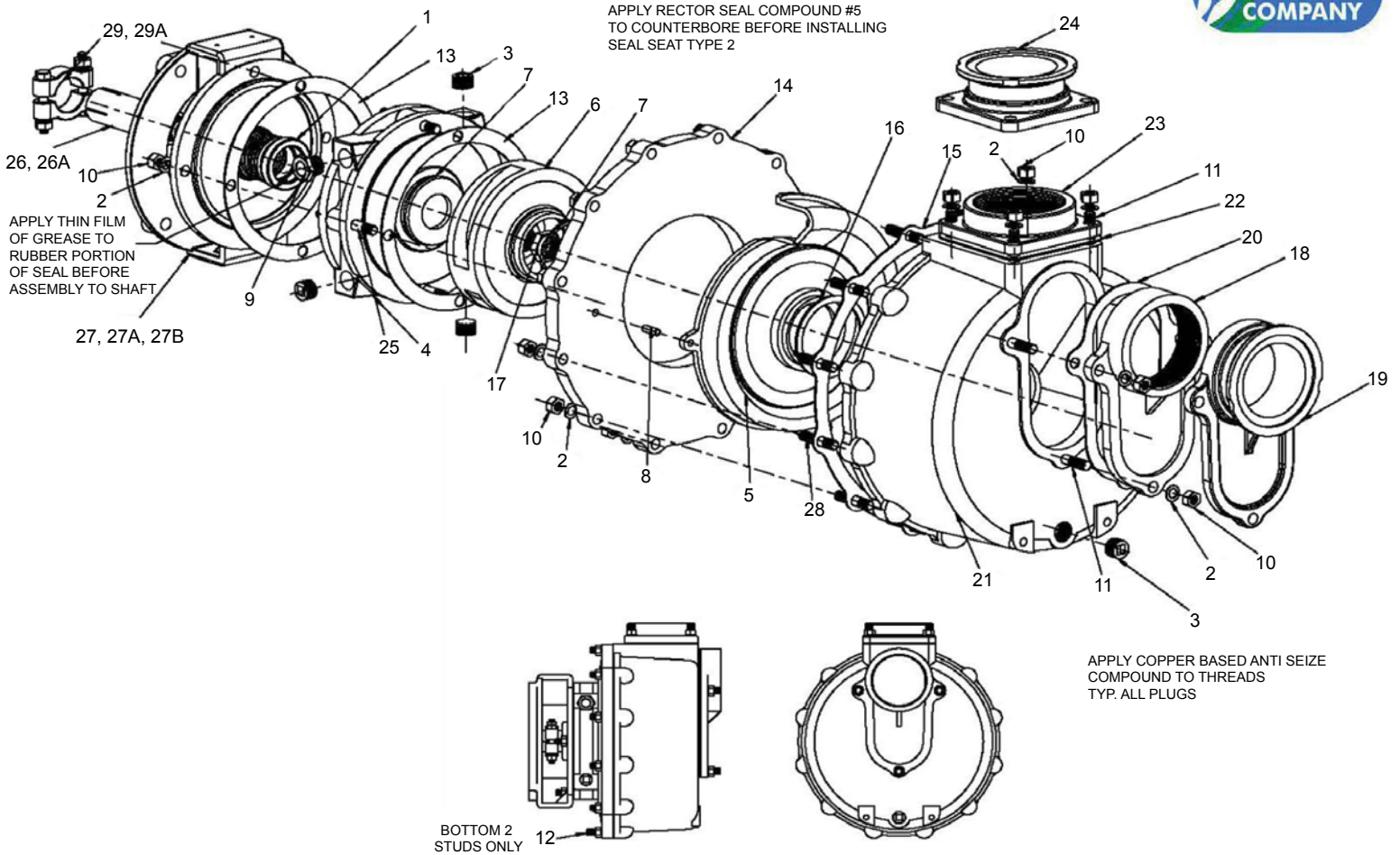

ITEM	QTY	PART NO.	DESCRIPTION
1*	1	43005	Double Mechanical Seal
	1	43071	Double Mechanical Seal (Optional Carbide Seal)
2	23	93025	3/8" Lockwasher. S.S.
3	4	95019	1/2" NPT Plug
4	1	102035-01	Reservoir
5	1	102036-01	Scroll Plate
6	1	102037-01A	Impeller
7*	2	110152-01	Annular Seal
8	2	L-4135	1/4" X 3/4" Roll Pin, S.S.
9	1	S-3555	View Window
10	23	S-3557	3/8" Nut S.S.
11	7	S-3561	3/8" X 1-5/8" Stud, S.S.
12	2	S-3597	3/8" X 2" Stud, S.S.
13*	2	S-3638	Gasket Seal
14	1	S-3640	Housing Cover
15*	1	S-3641	Gasket, Housing Cover
16*	1	S-3648	Gasket, Scroll Plate
17	1	S-3649	3/4"-16 Left Hand Locknut
18	1	S-3652	Suction Flange, 3" F.P.T.
19	1	S-3652-FLG	Suction Flange, Manifold 300
20*	1	S-3654	Gasket, Suction Flange
21	1	S-3655	Housing
22*	1	S-3656	Gasket, Flange
23	1	S-3657	Discharge Flange, 3" F. P. T.
24	1	S-3657-FLG	Flanged Adapter
25	4	S-3664	3/8" x 3-1/2" Stud, S.S.
26	1	S-3646	Impeller Shaft, 1-1/8"
26A	-	114524-01	Impeller Shaft, 1" For "BS" Gas Engine Model
27	1	102189-01	Adapter, Gas Engine 1-1/8" Shaft
27A	-	102190-01	Adapter, Electric Motor
27B	-	114523-01	Adapter, "BS" Gas Engine 1" Shaft
28	10	S-3666	3/8" x 1-7/8" Stud, S.S.
29	1	S-3608S	Clamp Assembly, 3" S.S.
29A	-	S-3608AS	Clamp for "BS" Impeller Shaft, S.S.

Spray Advantage

*** 103278
Repair Kit, Gaskets and Seal**